

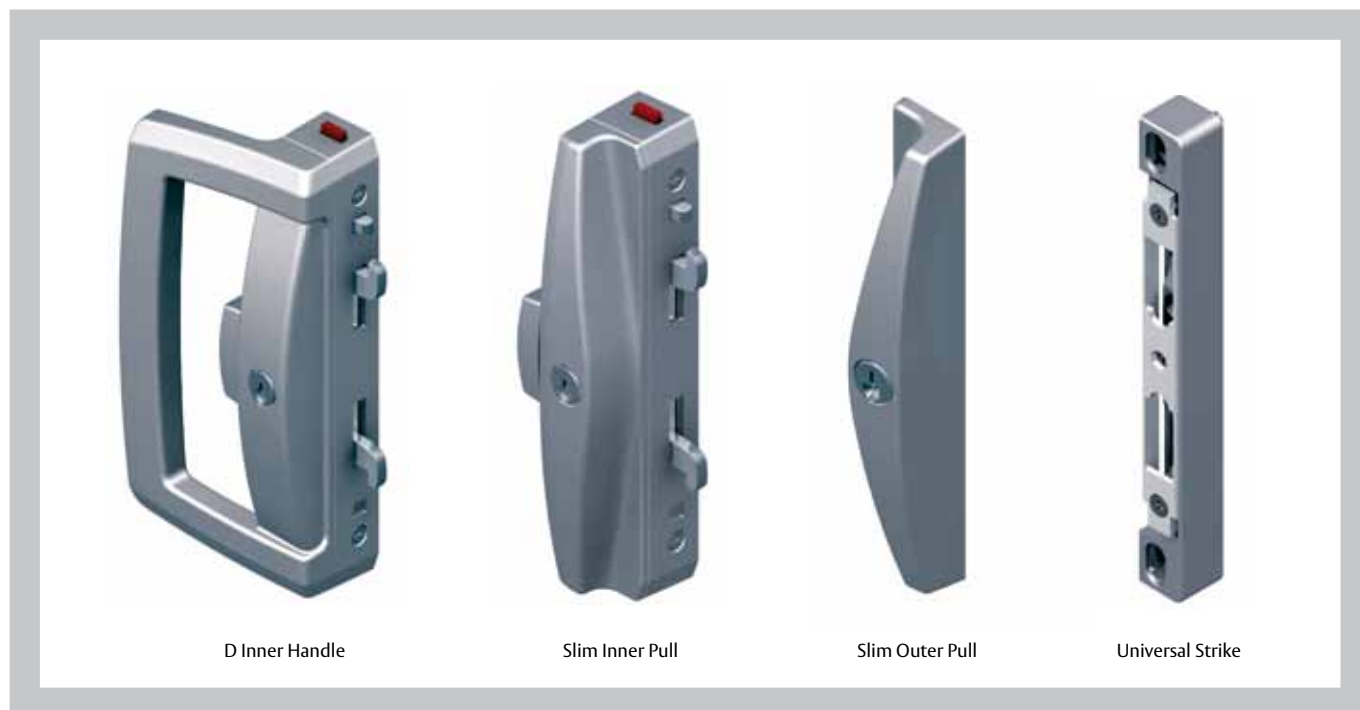

Sliding Patio Door Locks

Sliding Door Locks

Onyx® Sliding Patio Door Lock



The Lockwood Onyx range incorporates advanced security and safety features making this product the ideal choice for sliding patio door applications.

Style and Function

This range takes design cues from contemporary architectural styling and complements several of Lockwood's most popular levers to provide a harmonious look and feel throughout the home.

The functionality of the Onyx range has been enhanced by the intuitive operation of the unique sliding snib and the innovative LockAlert feature that indicates the lock status at a glance.

Application

Surface mounted lockset suitable for use with most aluminium and timber sliding doors.

The flexible chassis coupled with innovative design features results in a non-handed product that is extremely easy to install and suitable for new and most retrofit applications.

Features

- Twin locking beaks for added security
- Door Close Detect button (DCD) anti slam feature protects locking beaks from accidental damage
- **LOCKALERT** indicator shows lockset status at a glance
- **DUALSELECT** enables two stage key locking
- **SAFETYRELEASE** function minimises the risk of being locked in
- Ergonomic sliding snib with intuitive downward motion to unlock

Strength and Durability

Made to the highest quality levels, the Onyx range satisfies the Australian Standard requirements for strength and durability.

Product Range

A wide selection of furniture options are available in the Onyx range to suit various sliding door applications. The range includes internal D handles and slim pulls and a variety of external furniture and strike options.

Sliding Door Locks

Onyx® Sliding Patio Door Lock



Door Thickness

Door thickness range 19mm to 50mm with the standard screw fixing pack provided.

Longer screws and tailbars are available upon application.

Fixing

Surface mounted lockset with concealed fixing. Industry standard 82mm pitching centres.

Handing

Field selectable handing enables selection of handing during installation.

Keying

Standard Keying

- Supplied individually keyed with two keys per lock
- 78,000 key combinations
- Key blank KB2015P

Restricted Special Keying

Lockwood locks can be keyed to a number of controlled and/or specially keyed systems. These range from legally protected keys to protect against unauthorised duplication, which can also include specially designed key systems such as master key systems, which allow for different levels of mechanical access control.

Please refer to section 7 for keying systems or contact your local sales office or customer service for specific information.

Materials

- Zinc diecast construction
- Brass cylinders (Satin Chrome Pearl finish)

Standards

Conforms to Australian Standard AS4145.2:2008. Mechanical Locksets for Doors and Windows in Buildings.

- Physical security – S4
- Durability – D8

Standard Finishes

Black Powdercoat	BLK
Silver Powdercoat	SIL
White Powdercoat	WH
Satin Chrome Pearl	SP

Other plated and powdercoated finishes available as special order.

D Inner Handle

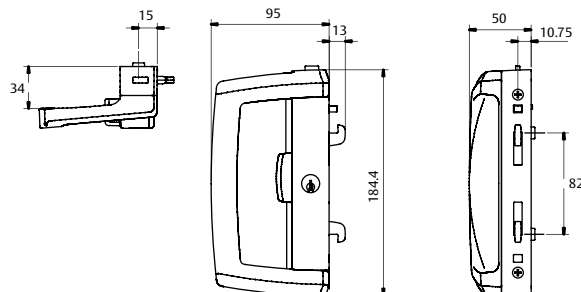

Slim Inner Pull

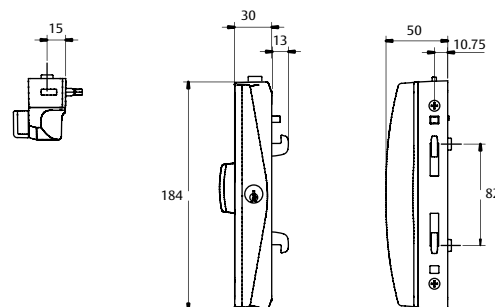

Slim Outer Pull

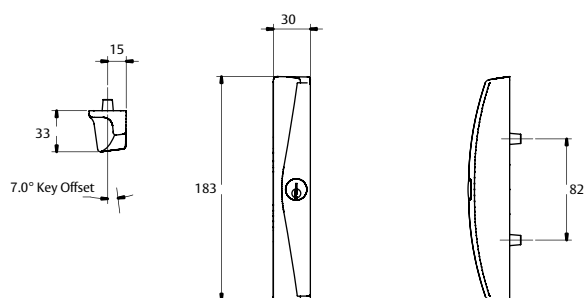

Sliding Door Locks

Flat Outer Pull

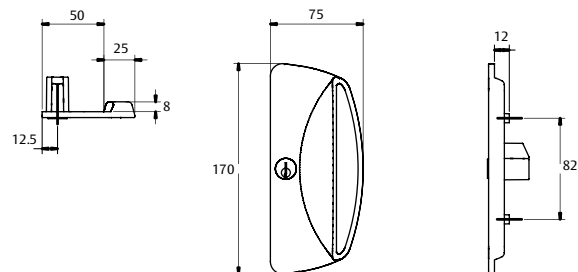

Mortice Outer Pull

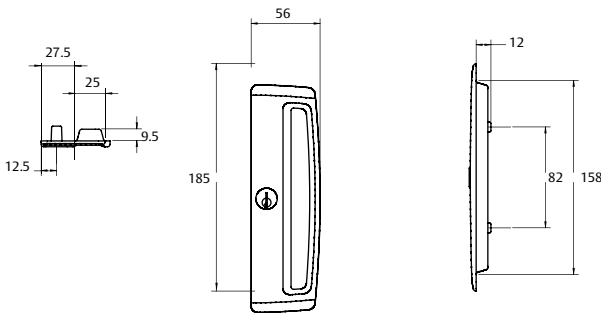

Cover Plate

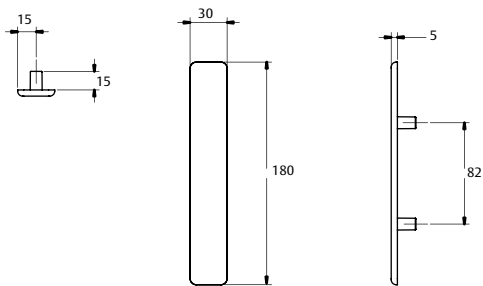

Universal Strike

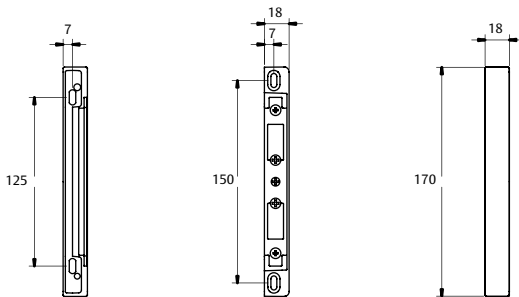

Extra Width Strike

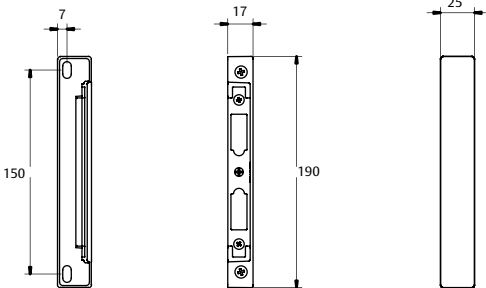

Side Fix Strike

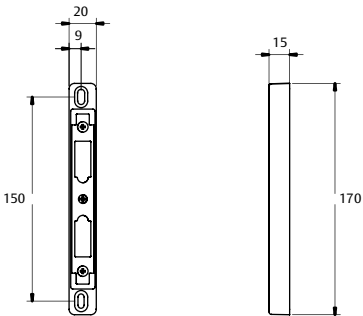

Surface Fix Strike

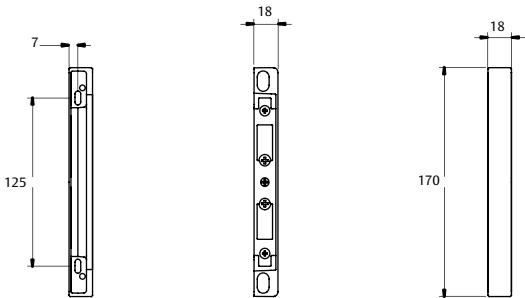

15mm Surface Fix Strike

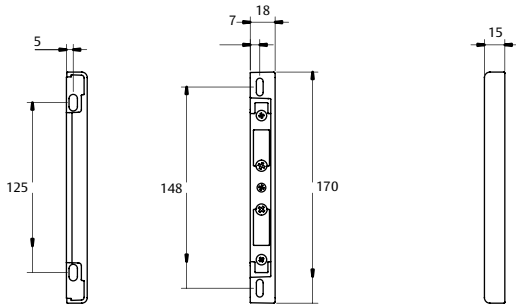

Sliding Door Locks

Onyx® Sliding Patio Door Locks Ordering Procedure

Configuration Matrix [For Reference Only]

Sample part number 9A1B2/5PBLK is made up of several sections.
Choose your product by selecting an option from each section.

For example:

Platform / Suite	Internal Furniture	External Furniture	Strike	Cylinder	Finish
9A	1	B	2	5P	BLK

Platform / Suite	External Furniture	Strike
Lockwood Patio Door, Style A 9A	No External Furniture * X	No Strike 0
	Slim Pull Locking A	Surface (Front) Fix 1
	Slim Pull Non Locking B	Universal Fix 2
	Flat Outer Pull Locking C	Extra Width Surface Fix 3
	Flat Outer Pull Non Locking D	Side (Face) Fix 4
	Mortice Pull Locking E	Surface 15mm Fix 5
	Mortice Pull Non Locking F	
	Cover Plate G	
	D Handle Locking H	
	D Handle Non Locking I	
	* Exterior furniture plate is required to fix internal furniture to door with through screws.	
Internal Furniture	Cylinder	Finish
No Internal Furniture * 0	5 pin Cylinder/s 5P	Black BLK
D Handle Locking 1	6 pin Cylinder/s 6P	Silver SIL
D Handle Non Locking 2	No Cylinders NC	White WH
Slim Pull Locking 3	– order cylinder separately	Satin Chrome Pearl SP
Slim Pull Non Locking 4	Non Keyed Lockset XX	Polyester Powder Coat* PPC
D Handle Dummy 5		
Slim Handle Dummy 6		
DAS Handle Locking (D with aided snib) 7		
DAS Handle Non Locking (D with aided snib) 8		

Furniture comes complete with lock or dummy chassis and fixing screw pack to suit 19 – 50mm thick doors.

* No internal furniture option will also come less lock chassis.

* Specify colour (Dulux number), additional lead time and costs apply.

^ Part number convention is for reference only, not all possible combinations will be available as a pre packed lockset. Some configurations will need to be made up of sub-assemblies. i.e. Two or more line items may be required to make up desired configuration.

The Lockwood 8653 Sliding Door Lock has been designed in Australia and manufactured to stringent quality specifications. The range has been tested in accordance with AS4145.2-2008, offering exceptional performance and reliability.

Incorporating Lockwood's advanced safety and security features, DualSelect® and LockAlert® the 8653 Sliding Security Door Lock is ideal for use in residential applications.

Features and Specifications

- **DUALSELECT** 2 stage key locking, offers safety and security for all occupants by giving a choice of selecting privacy lock or deadlock when exiting the home
- Turning the key to the first selection engages the privacy lock, this offers security from the outside whilst allowing occupants inside to safely exit using the internal lever
- Turning the key to the second selection engages the deadlock, this provides internal and external security, and requires the key to unlock the door from inside and outside

LOCKALERT

The LockAlert feature added to the 8653 Sliding Security Door Lock range allows you to see if the inside lever is key locked at a glance.

- **Secure Mode**
Locked from both inside and outside.
- **Safety Mode**
Locked from outside and free to exit from inside.
- **Passage Mode**
Free to enter from outside and free to exit from inside.

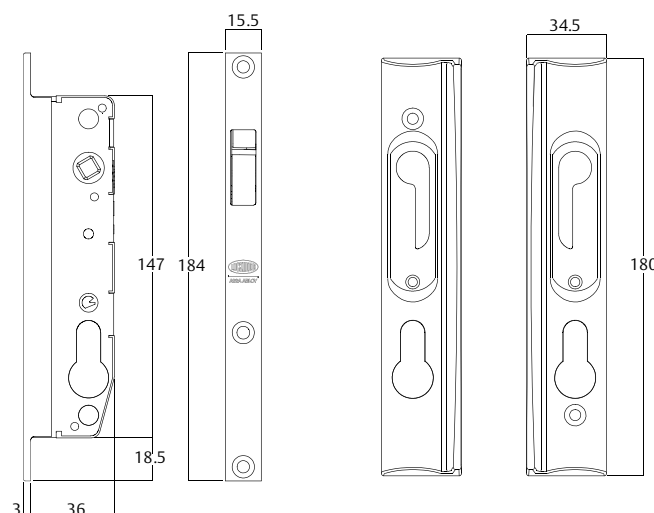
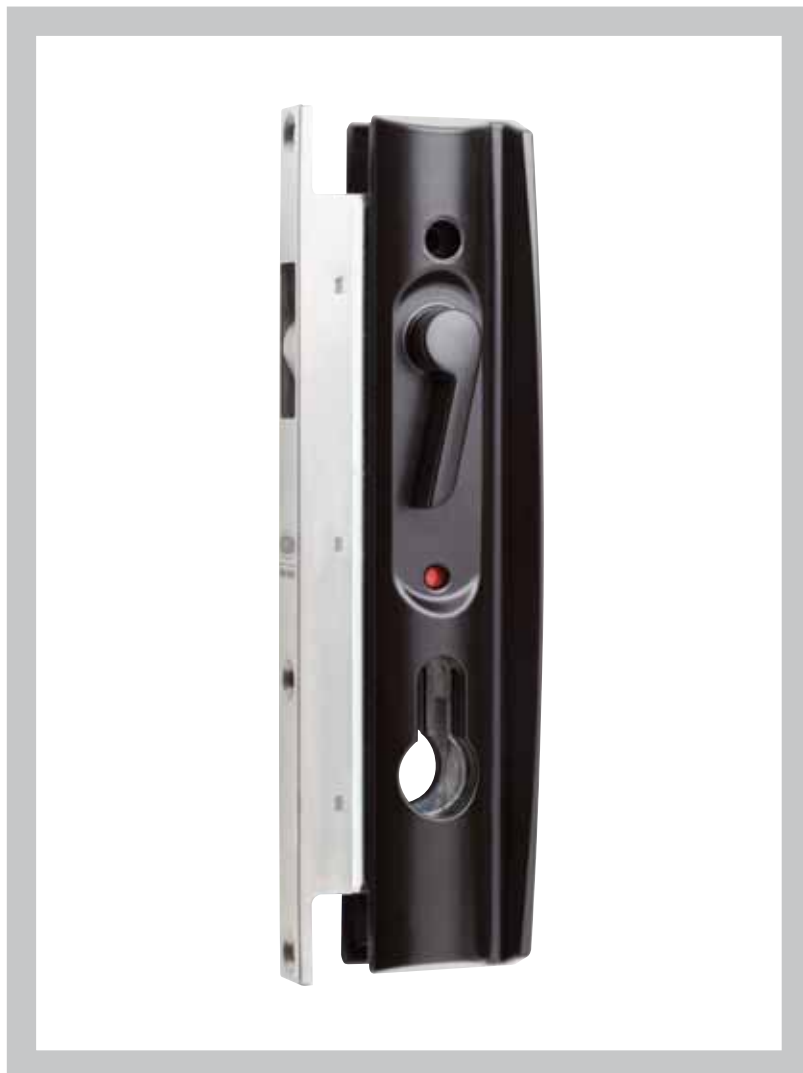

Sliding Door Locks

8653 Sliding Security Screen Door Lock

Features and Specifications (Continued)

This high performance lock meets or exceeds the requirements of Australian Standard AS 4145.2 – 2008: Locksets and Hardware for Doors and Windows Part 2: Mechanical Locksets for Doors and Windows in Buildings. To Level S7 and D8.

Successfully tested on security screen doors in accordance with Australian Standard AS 5039-2008: Security Screen Doors and Security Window Grilles and AS 5041-2003: Methods of Test.

- Suits left or right hand closing doors
- Key locking from both sides
- Inside snib locking (with key override)
- Snib only version also available
- Stainless steel front end plates
- Self latching with stainless steel parrot beak deadlatch
- Can only be locked when fully engaged with strike
- Stainless steel strike available for single point locks
- Optional 3 point kit available for premium security
- When 3 point kit is fitted, snib activates/operates all 3 locking points
- Available in a range of polyester powdercoat and plated finishes
- Fits industry standard cut outs/door preparation
- Retrofits previous Whitco Leichhardt Lock
- Zinc diecast lock mechanism and furniture
- Easy installation for both new and retrofit applications
- Accepts Lockwood Euro profile lazy cam cylinder
- Suit standard 20mm door thickness
- Available in display and trade packs

Application

Single or multi point mortice sliding security door lock available in high strength (3 point) and standard versions. A snib only mortice lockset is also available.

Order Code	Product Description
8653BLK	Single point lockset no cylinder - Black
8653PRM	Single point lockset no cylinder - Primrose
8653WH	Single point lockset no cylinder - White
8653CP	Single point lockset no cylinder - Chrome Plate
8653SP	Single point lockset no cylinder - Satin Chrome Pearl
8653BLKDP	Single point lockset with cylinder - Black (display pack)
8653BLKSO	Single point snib only lockset - Black
8653-3PK	3 point kit
SP8653-53	High strength strike
8650-2CP	Anti drill cylinder

Note: Lockset includes furniture, snibs, strike, installation instructions and screw packs.

Keying

- Use with Lockwood Euro profile lazy cam cylinder
- 2 x 5 pin cylinder
- Can be keyed alike to other Lockwood door and window products

Standard Finishes

Polyester powdercoat

- Black
- Primrose
- White

Plated

- Chrome Plate
- Satin Chrome Pearl

Accessories

- Standard multi point kit
- High strength strike kit

8653 Line Diagrams

3 Point Locking Kit

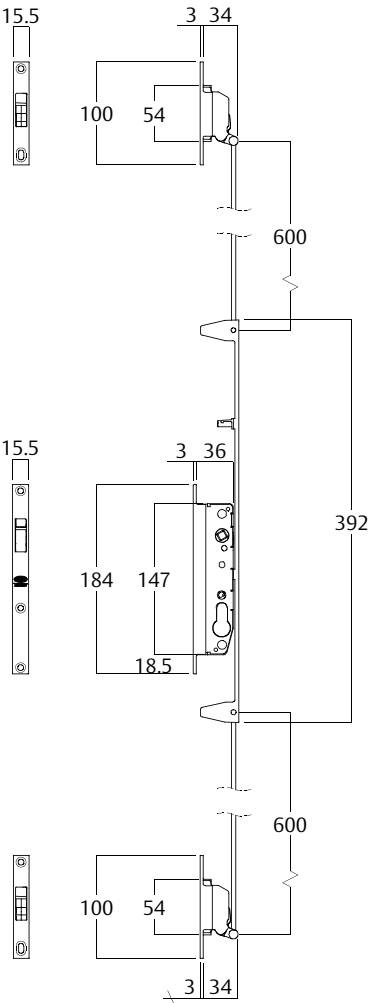

Standard Strike (Zinc)

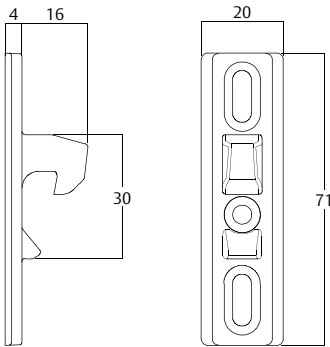

High Strength Strike (Stainless Steel)

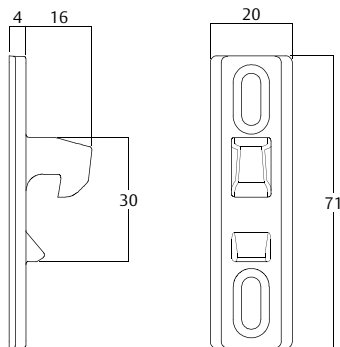

Auxiliary Strike/3 Point

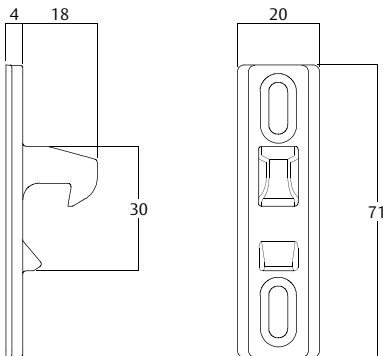

ASSA ABLOY is the global leader in door opening solutions, dedicated to satisfying end-user needs for security, safety and convenience



Lockwood is the leading brand in the Australian locking industry. With an established reputation for high quality products, this iconic brand provides a wide range of locking solutions to residential housing, commercial building and industrial application markets. Lockwood is supported by an extensive distribution and after-sales support network. Our customers include retailers, architects, trade and industrial personnel, locksmiths and security dealers.



ASSA ABLOY is the global leader in door opening solutions, dedicated to satisfying end-user needs for security, safety and convenience.

ASSA ABLOY is represented in all major regions, in both mature and emerging markets, with leading positions in Australia, Europe and North America.

As the world's leading lock group, ASSA ABLOY offers a more complete product range of door opening solutions than any other company in the market.

Australia
1300 LOCK UP (1300 562 587)
lockweb.com.au

New Zealand
+64 9415 7111
assaabloy.co.nz

ASSA ABLOY Australia Pty Ltd
235 Huntingdale Road
Oakleigh, Victoria, 3166
Australia

info.au@assaabloy.com
assaabloy.com.au

ASSA ABLOY New Zealand Ltd
6 Armstrong Road
Albany, North Shore City, 0632
New Zealand

info.nz@assaabloy.com
assaabloy.co.nz

